

**Suprajit Successfully Completes
Acquisition of Light Duty Cable (LDC)
Business Unit of Kongsberg Automotive**

Date: April 6, 2022

**Enabling
A World
In Motion**

- **Suprajit Engineering Ltd has completed the acquisition of all the legal entities and assets of Kongsberg Automotive's Light Duty Cables (LDC) business unit**
- **LDC is transformative for Suprajit**
 - **Expected to add \$100 Mil+ in revenue with double digit EBITDA in the next two years.**
 - **Strategically located in Mexico, USA, Hungary and China**
 - **Significantly expands Suprajit's automotive footprint in Americas and Europe while further improving our position as the leader in Non-Automotive and Off-Highway controls in both Geographies.**
 - **LDC's Shanghai Lonestar plant is a reputed cable business in China and will allow Suprajit to offer a new key manufacturing location to our customers**
 - **LDC's Electro-mechanical Actuators will become new product segment to Suprajit**
- **Jim Ryan, President Global Operations will lead the acquired entities in addition to his current responsibilities at Wescon Controls LLC (USA) and Suprajit Europe Ltd.**
- **The current installed capacity of LDC division is 106 Million cables per annum. With this acquisition the group's cable installed capacity will increase to 400+ Million cables per year.**
- **The enterprise value of this transaction is 42.00 Million USD which will be subject to standard closing review adjustments**

LDC as Part of Suprajit



| | Cable Manufacturing Facilities | | | | | Capacity |
|--------------------------|--------------------------------|-------------------|-----------------|-----------------|------------|------------|
| | China | Hungary/UK/Europe | India | Mexico | USA | Global |
| Suprajit | No | Warehousing | PV + OFH | OFH | OFH | 300 |
| LDC | PV + OFH +2W | PV + OFH | No | PV + OFH | No | 106 |
| Suprajit with LDC | PV + OFH+2W | PV + OFH | PV + OFH | PV + OFH | OFH | 406 |

PV – Passenger Vehicle (Automotive)

OFH – Off Highway (Agriculture, Outdoor Power Equipment, etc)

2W – Motorcycles (2-Wheelers)

■ 2 Wheeler ■ Aftermarket ■ Automotive ■ Non-automotive

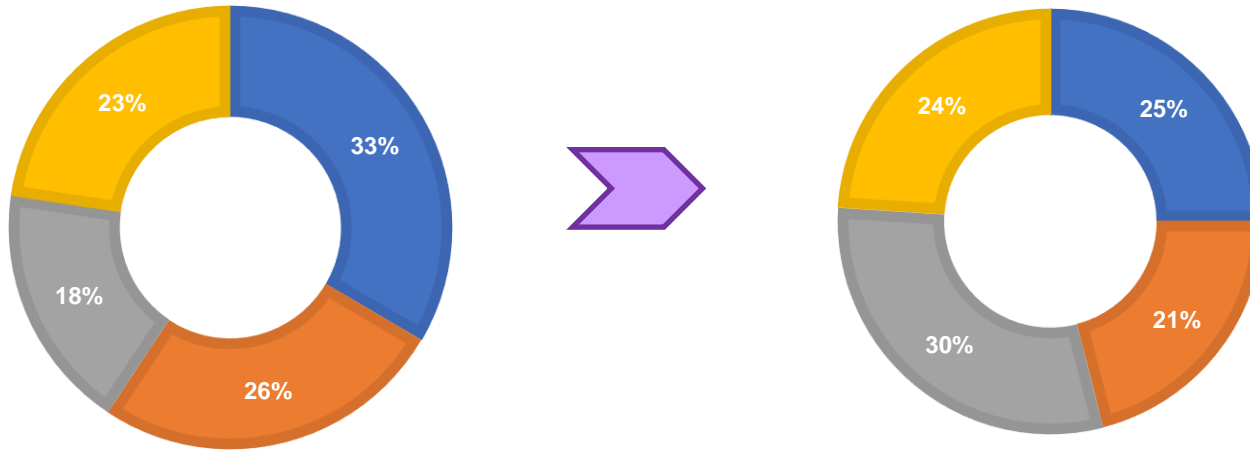

LDC's Automotive Exposure improves Suprajit's diversification and reduces Two Wheeler Exposure to 25%

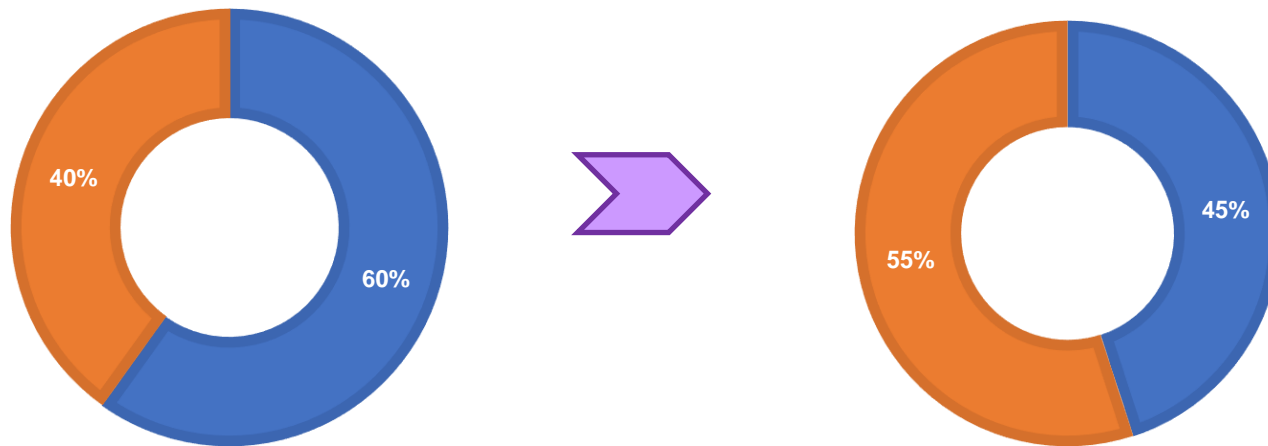

Transformational Acquisition that makes Suprajit a truly Global Automotive Ancillary with further de-risked revenue streams

■ India ■ Global

Before LDC: Technology Centers of Suprajit

- USA – Supports OFH
- UK – Supports Automotive
- India – Supports All Verticals

Technology Centers with LDC

- USA – Supports PV & OFH
- UK – Supports PV & OFH
- Germany- Supports PV & OFH
- China – Supports All Verticals
- India – Supports All Verticals

LDC brings Strong Customer Connect

- Suprajit's Core Cable Engineering to a Customers' Doorstep
- Possible introduction of new products from STC



Allied Motion Control Parts



Vehicle Lighting



Instrument Clusters



Control Cable Mechanisms

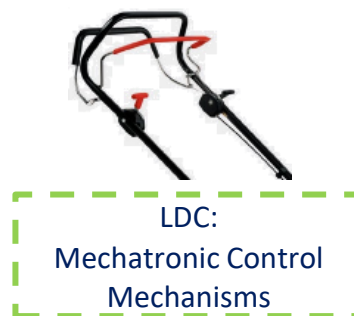
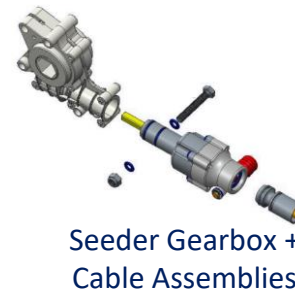

LDC brings premiumisation focused Technologies that are nascent in India

LDC's Select customers



“Perfect Match” of Customer Bases

- LDC has been a respected global leader in the cable business
- Global leadership position has led to a diversified global customer base just like Suprajit (in India)
- Since Suprajit and LDC have had different focuses within the cable segment, there is very little overlap in customers/platforms
- LDC is on various global EV platforms including Tesla
- Strong Relationships with Customer's Engineering Teams will help Suprajit bring more engineered solutions to the table

Suprajit Group with LDC will have no single customer exposure greater than 10%

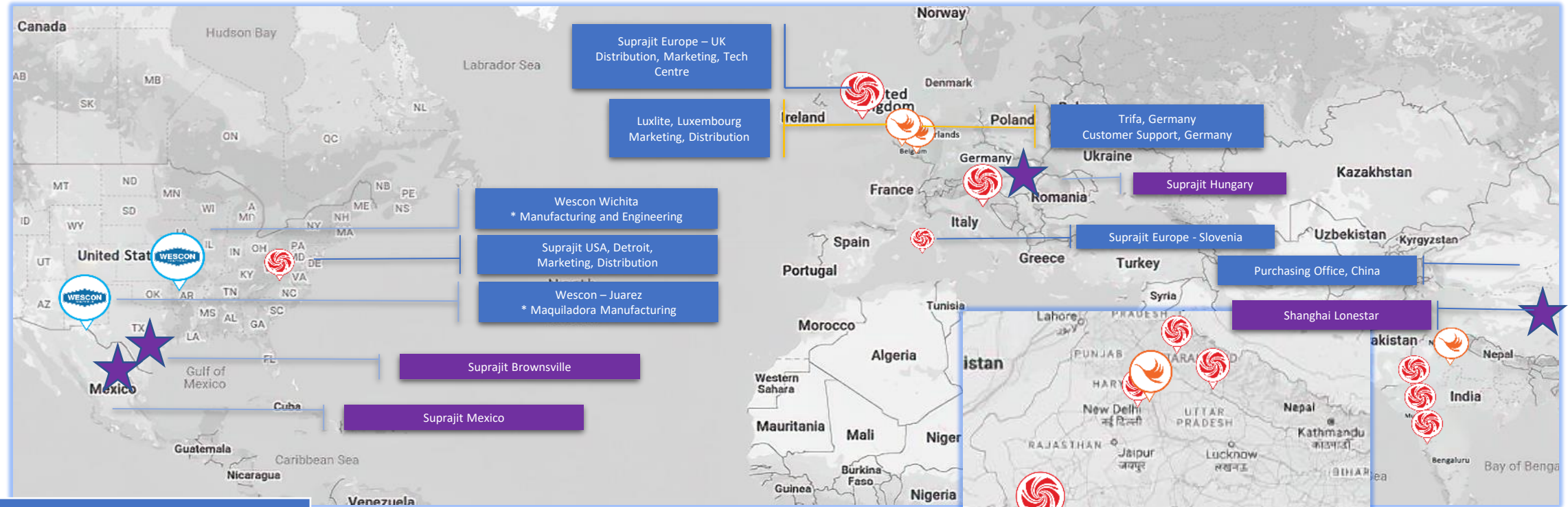

| Manufacturing Plants | |
|----------------------|-----------|
| India | 18 |
| US | 1 |
| Mexico | 1 |
| LDC Plants | |
| Mexico | 1 |
| Hungary | 1 |
| China | 1 |
| US | Warehouse |

Phoenix:

- Noida 2 Plants, SEZ & DTA
- Chennai – 1 Plant

Suprajit – India:

- Headquarters,
- Global Manufacturing Hub
- 15 Strategically located plants

LDC also has Strong Sales and Engineering teams in Novi (Detroit USA), Burton (UK), Munich (Germany), and at each plant location (Mexico, Hungary, China)

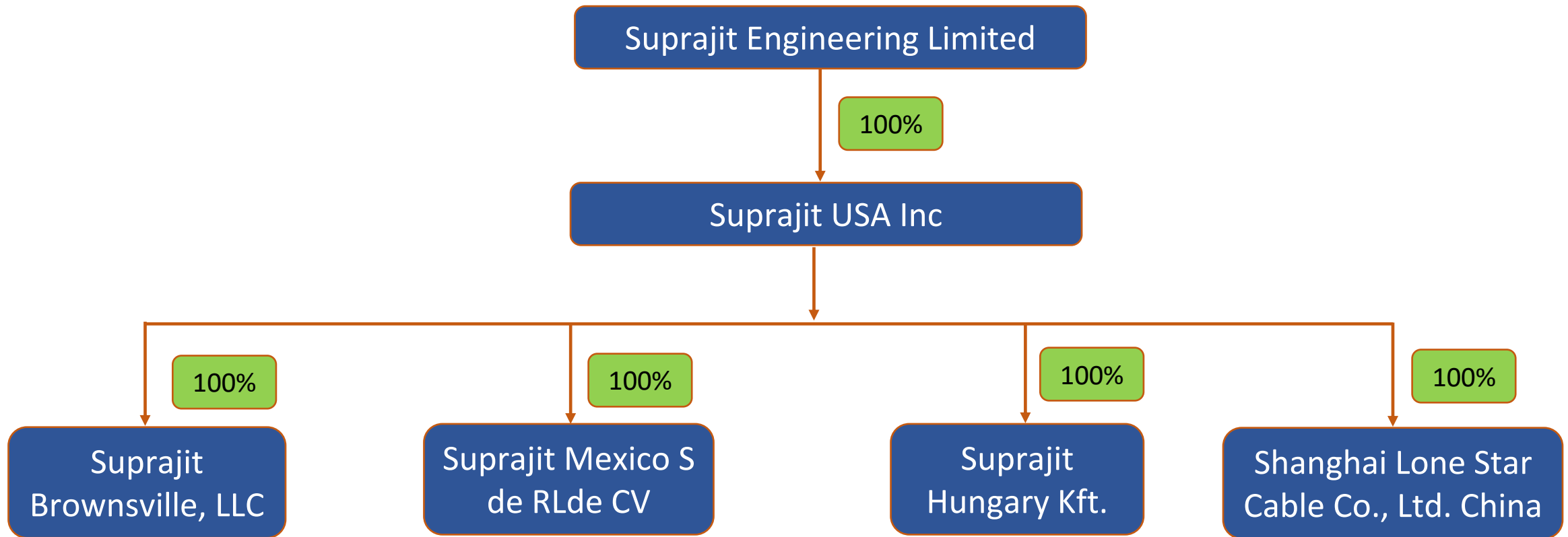

Suprajit Engineering Limited

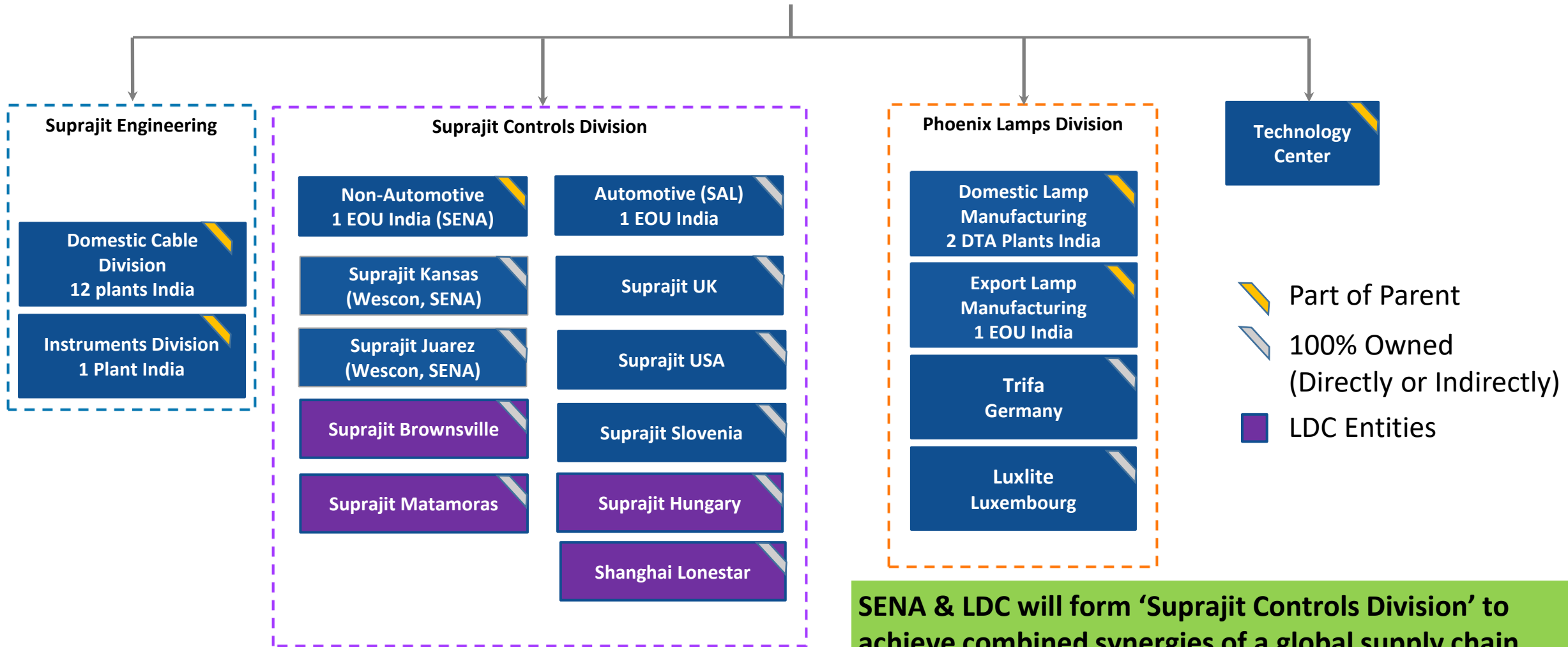

SENA & LDC will form 'Suprajit Controls Division' to achieve combined synergies of a global supply chain, and strong local engineering and sales teams

Thank You